

NOTES:

1. MATERIAL: .058 THICK C26000 BRASS; 1/2 HARD, ANNEALED TO TEMPER, PER ETCO METAL CODE 00935.
2. PARTS MAY BE COATED WITH A LIGHT FILM OF LUBRICATION USED IN THE MANUFACTURING PROCESS.
3. WIRE RANGE: #6 AWG.

Rev.	Description of Change/ SCN#	Date
1	TRANSFERED FROM CP SCJ	8-18-08

P/C	DESCRIPTION	MAT'L	DIM "X"
82357	R556E-375-HB	NOTE 1	Ø .375
82356	R556E-350-HB	NOTE 1	Ø .350
82355	R556E-14-HB	NOTE 1	Ø .250

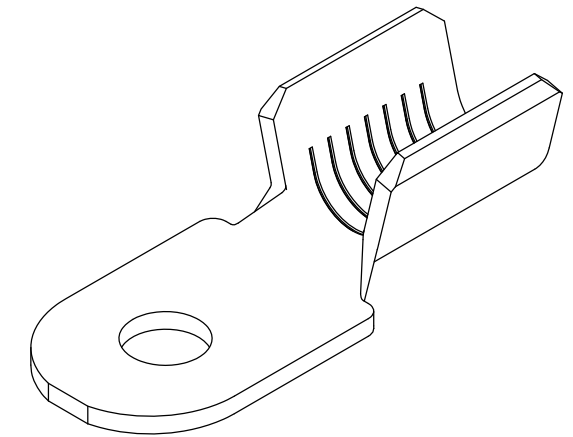
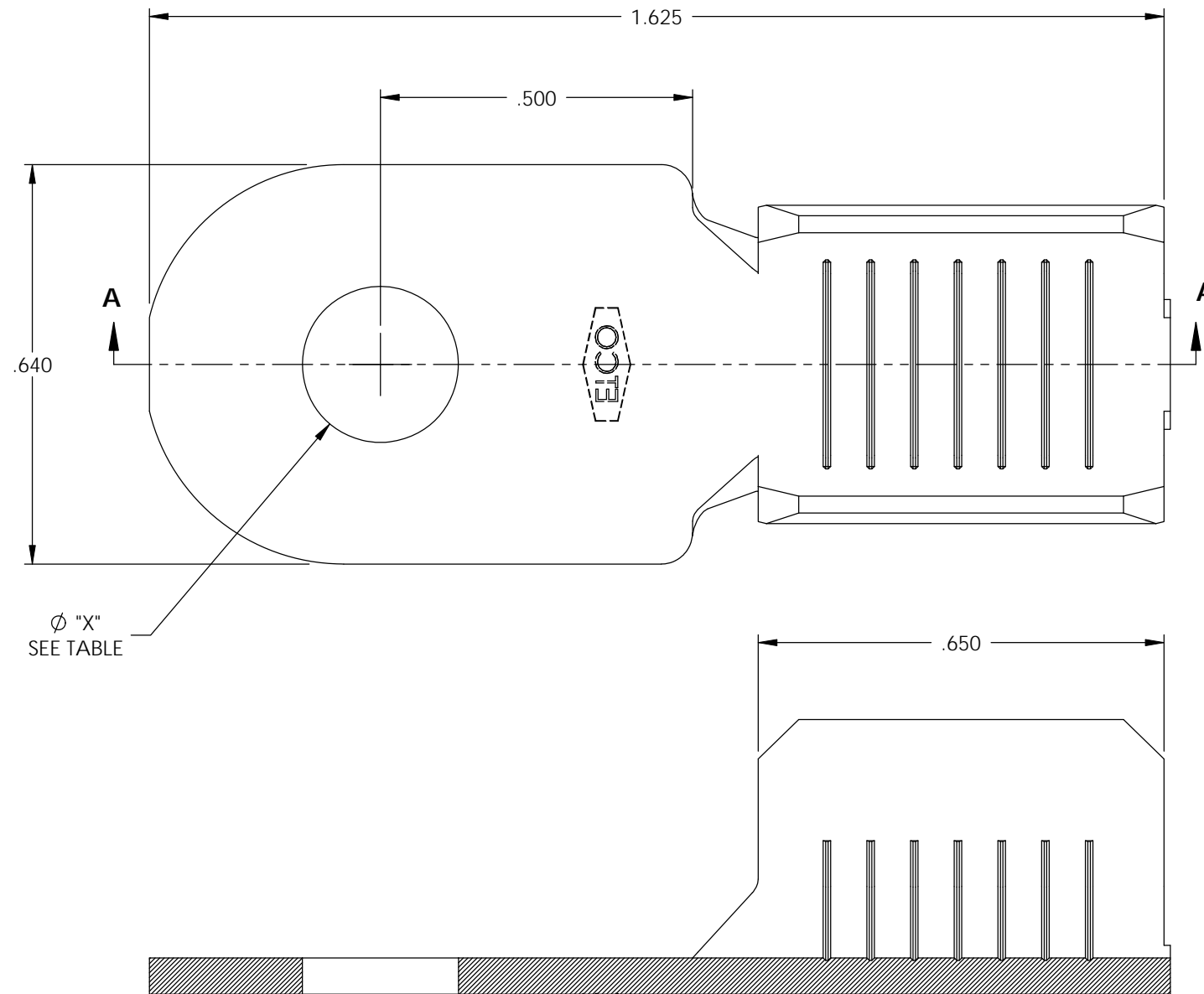

SECTION A-A

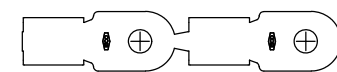

DIRECTION EXITING TOOL
EARS DOWN, TO THE LEFT

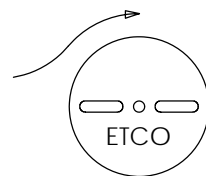
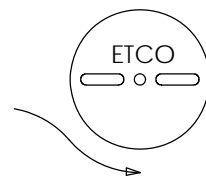

DIRECTION TOWARDS APPLICATOR
EARS UP, TO THE RIGHT

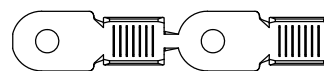

UNCONTROLLED COPY

<p>THIRD ANGLE PROJECTION TOLERANCES UNLESS OTHERWISE SPECIFIED INCHES: .XX - ±.030 .XXX - ±.015 ANGLES: ±5°</p>	<p>TOOL NO. 0843</p>	<p>Title: RING TERMINAL</p>		
		<p>DO NOT SCALE DWG.</p>	<p>Drawn By: S.JOHNSON</p>	<p>Date: 8-18-08</p>
<p>ETCO Incorporated Engineered Products 25 Bellows Street Warwick, RI 02888 Phone: (401) 467-2400 Fax: (401) 467-9230 www.ETCO.com</p>		<p>Chk'd/App'd By:</p>	<p>Scale: 4X</p>	<p>Size B</p>
		<p>Dwg. No.: R556E cust</p>		