

NOTES:

1. MATERIAL: .016 THICK, S430 STAINLESS STEEL, BRIGHT ANNEALED, PER ETCO METAL CODE 0-0095.
2. PARTS MAY BE COATED WITH A LIGHT FILM OF LUBRICATION USED IN THE MANUFACTURING PROCESS.
3. WIRE RANGE: 8mm.

P/C	DESCRIPTION	MAT'L	CLIP	REWIND
15290	SP955-SS	NOTE 1	SCA4-G	NO
15297	SP955-SS-R	NOTE 1	SCA4-G	YES

Rev.	Description of Change/ SCN#	Date
1	Redrawn in SW from ACAD SCJ Org.Eng.Dwg.Date: 6/23/04	5/21/19

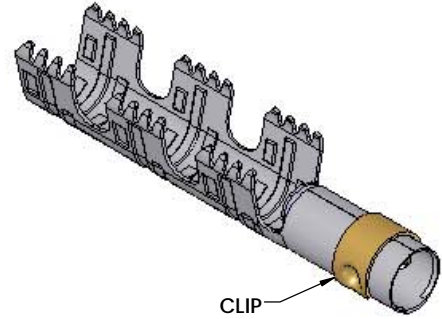

CLIP

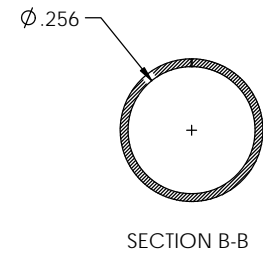
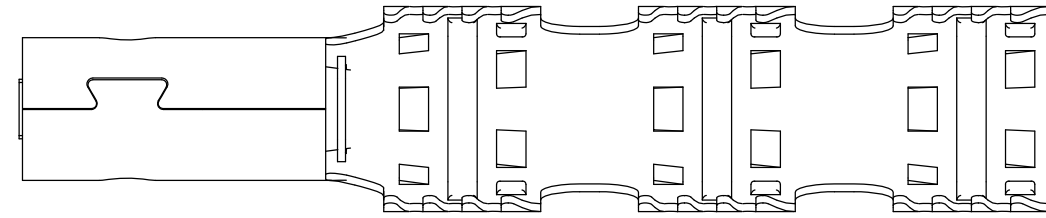

SECTION B-B

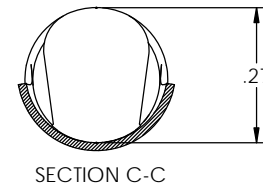

SECTION C-C

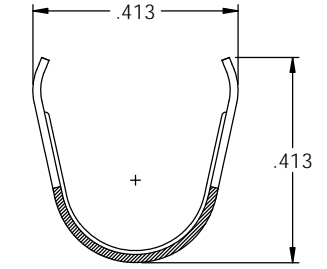
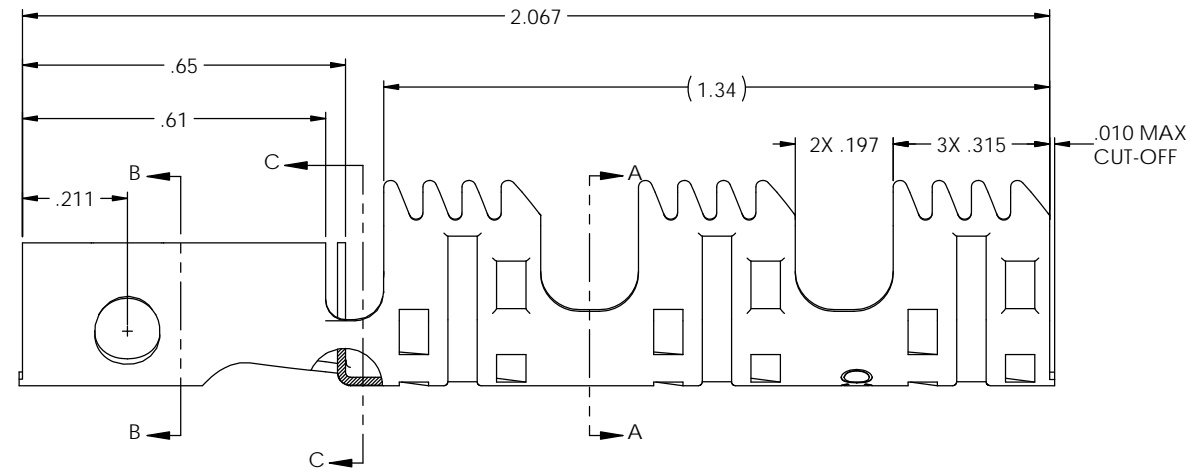

SECTION A-A

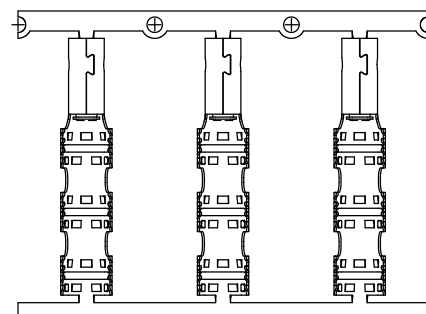
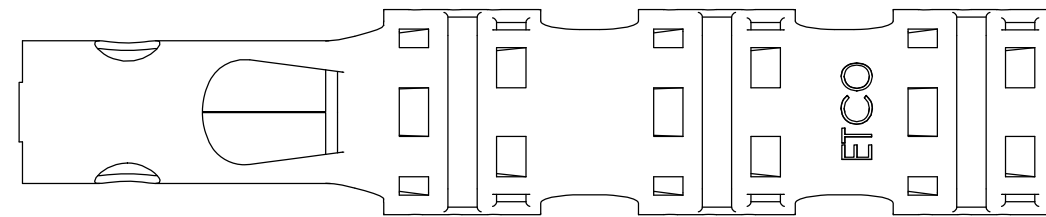

DIRECTION EXITING TOOL,
EARS UP, TO THE FRONT

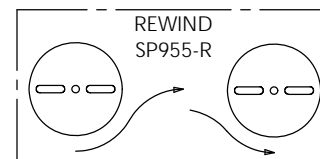

REWIND
SP955-R

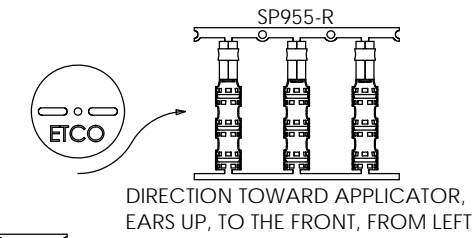

DIRECTION TOWARD APPLICATOR,
EARS UP, TO THE FRONT, FROM LEFT

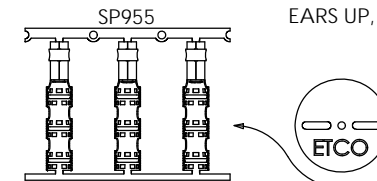

DIRECTION TOWARD APPLICATOR,
EARS UP, TO THE FRONT, FROM RIGHT

UNCONTROLLED COPY

<p>THIRD ANGLE PROJECTION</p>	<p>TOOL NO. 2249</p>	<p>Title: Spark Plug Terminal</p>			
		<p>DO NOT SCALE DWG.</p>	<p>Drawn By: S.Johnson</p>	<p>Date: 5/21/19</p>	<p>Scale: 4X</p>
<p>TOLERANCES UNLESS OTHERWISE SPECIFIED</p> <p>INCHES: .XX - ±.030 .XXX - ±.015</p> <p>ANGLES: ±5°</p>		<p>ETCO Incorporated Engineered Products 25 Bellows Street Warwick, RI 02888 Phone: (401) 467-2400 Fax: (401) 467-9230 www.ETCO.com</p>	<p>Chk'd/App'd By: ETCO</p>	<p>Dwg. No.: SP955 cust</p>	